

Chisholm Park and Cairn Park Design

Antigonish, Nova Scotia
April 2007

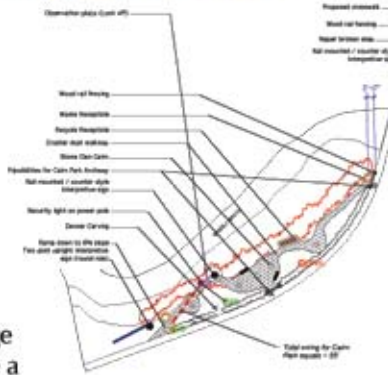

Chisholm and Cairn Park mark the entrance to the downtown of Antigonish. Through the vegetative based design and prominent signage the parks provide a stunning welcome to the downtown area. The vegetative buffer also creates a sanctuary from the cacophony of a busy downtown intersection. Both parks have an important historical significance and are located on one of the major waterways in Antigonish. Environova's design incorporates both important aspects through the design of a look off, interpretive signage and pathway design.

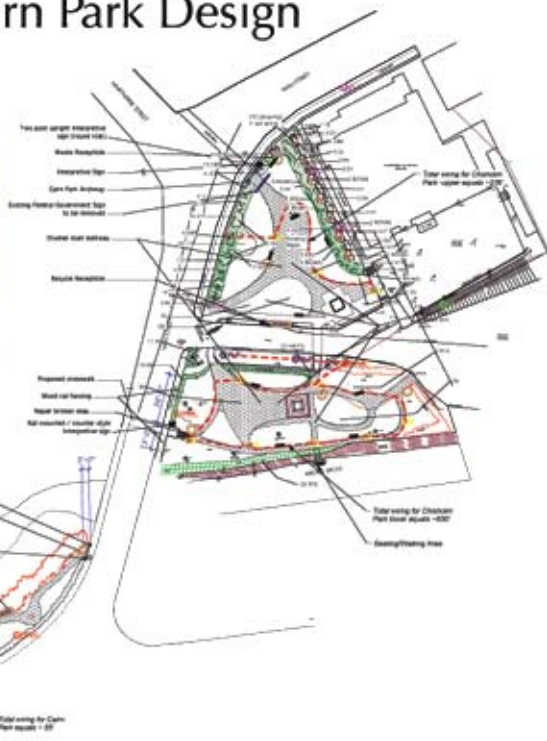

Legend		Notes
	Proposed path	This drawing includes the information work required for the project including utilities and gateway construction. Underground utility work shall be done prior to construction.
	Proposed path	
	Proposed path	Contractors should fence themselves with both park sites and work off ground when necessary.
	Proposed path	
	Proposed lighting	The location of existing street lamps and power poles, proposed street lamps and power poles (street lighting to be installed in the Phase 2) construction are indicated on this plan.
	Proposed lighting	
	Proposed signage	Site furnishings such as water and recycling receptacles, interpretation look-off for Cairn Park, urban gateposts, interpretive maps, wood rail fencing
	Proposed signage	
	Proposed fence	Existing Federal government sign shown on this plan is to be replaced or removed as a part of this contract. Arrangements are to be made between the Town of Antigonish and Public Works Canada.
	Proposed fence	
	Proposed utility	* All quantities are estimates to be verified by contractor after inspection of drawings.
	Proposed utility	

Chisholm Park and Cairn Park Design

 PLANNING, LANDSCAPE ARCHITECTURE & CONSULTING SERVICES	Town of Antigonish, Antigonish, Nova Scotia	Date: April, 2007	Scale: 1" = 40'
		Drawn By: J.P.	Design By: S.K. & J.P.
		Checked By: S.K.	Page: 1 of 1



Before

Chisholm Park

After



Before

Cairn Park

After

